

# Ozlogs landscape & retaining wall 100 u.c steel post (Quickfit fencing system)

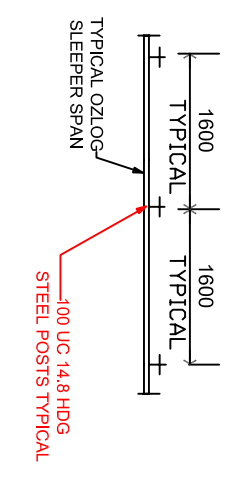

**OZLOGS SLEEPER ELEVATION**  
**Please Note: Some retaining walls may have to adhere to council specifications. Consult your local council, engineer or Ozlogs for further detail.**

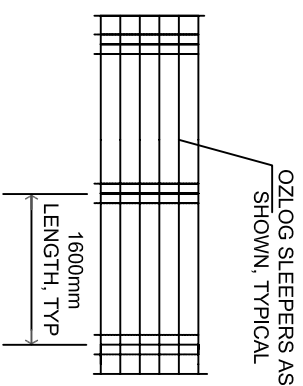
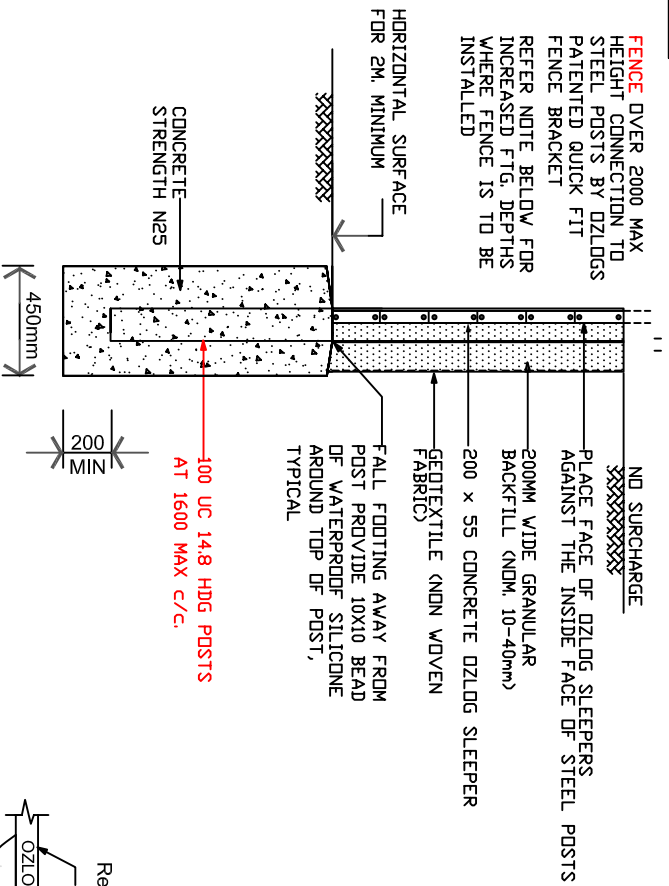
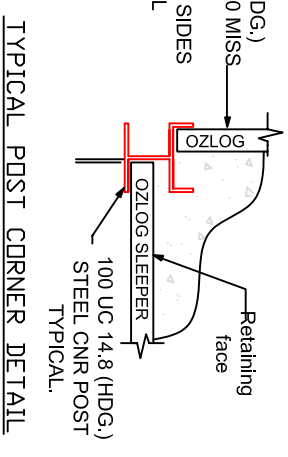
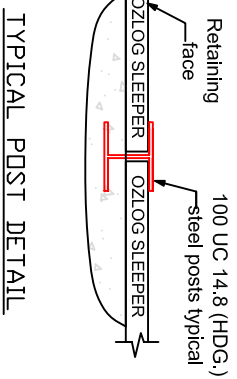

## OZLOGS CONCRETE SLEEPER RETAINING WALL

RETAINING HEIGHT UP TO 1200mm MAX.  
 INFORMATION ON WALLS ABOVE 1200mm CONTACT OZLOGS

### EASY STEPS FOR INSTALLATION:

1. Bore Piers according to technical information shown on drawings.
2. Place posts into bored piers, pour concrete and allow to set for 24 hours.
3. Place concrete Ozlogs sleepers within steel posts.
4. Lay geotextile fabric behind Ozlogs sleepers and fill course with gravel. (Nom. 10-40mm.)
5. Lay Ozlogs sleepers for second course and fill course width with gravel.
6. Repeat step 5 for height of wall.

FOOTING DEPTH	RETAINING HEIGHT	D' (mm)	H' (mm)
600	600	600	600
800	800	800	800
1000	1000	1000	1000
1200	1200	1200	1200

**Note: Where 2.0m high fence to be built over, increase footing depth and steel post by 200mm. (ie. Retaining Ht. 1200 + fence over = 1400 ftg. depth.)**

## TYPICAL POST DETAIL

### DESIGN SPECIFICATIONS/REQUIREMENTS

1. Walls shall be founded on stiff natural ground with a minimum of 100kPa bearing pressure.
  2. Retaining wall has been designed for no surcharge. For locations where a surcharge will apply an engineer must be consulted.
  3. Retaining wall is not suitable for locations where slip circle problems occur. A certified engineer shall be consulted if this condition occurs.
  4. Retaining wall has been designed for the following parameters:
    - Soil density 19k/m<sup>3</sup>
    - 30° Internal angle of friction for soil.
    - 100kPa minimum bearing capacity for bored piers.
    - No surcharge to be applied to the wall.
    - Reactivity of soil no worse than class 'M'.
- Where fence is to be placed over retaining wall, refer notes for increased footing depths.

## TYPICAL POST CORNER DETAIL



OZLOGS PTY LTD. email [info@ozlogs.com.au](mailto:info@ozlogs.com.au)  
[www.ozlogs.com.au](http://www.ozlogs.com.au)

